

# 2020-2023 Toyota Tacoma

Add Subwoofer(s) to stock stereo - fast & easy!

- No cutting or splicing factory wires!
- Works with most amplifier brands.
- Works with aftermarket stereos also!

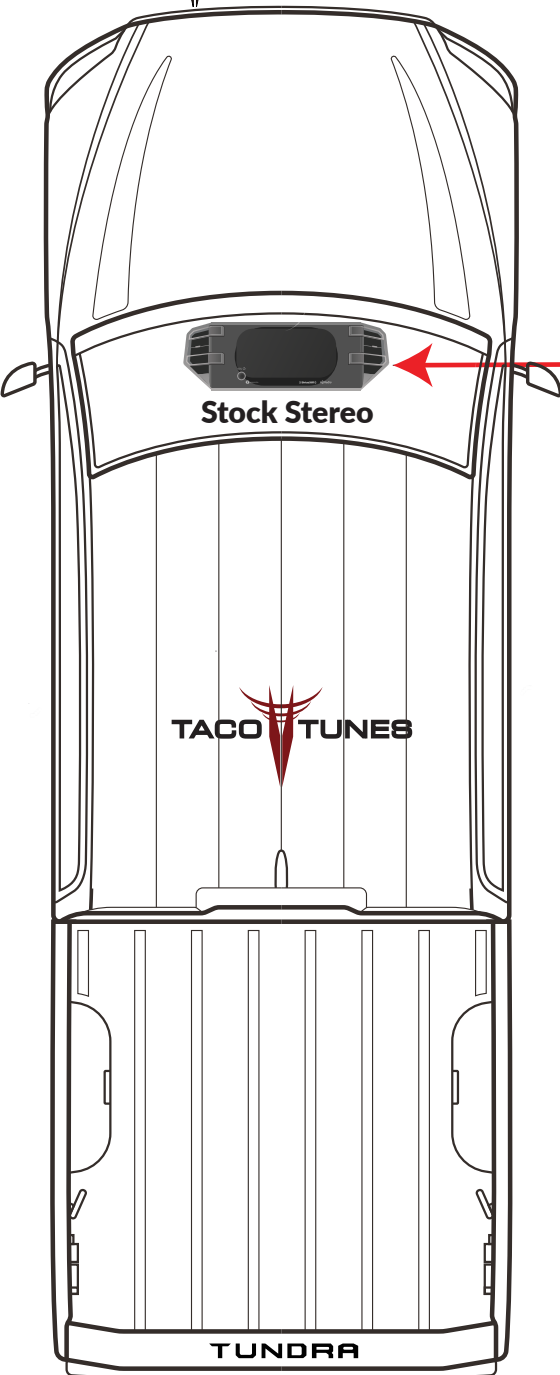

Stock wiring

Connect to  
**LOC/AMP/ POWERED SUB**  
(where applicable)

Tacotunes  
Remote Turn On/12V

Tacotunes  
Add a Subwoofer Harness

17 Feet

17 Feet

**CLICK HERE**  
Plug & Play Harnesses

# How to add a powered sub to stock stereo using tacotunes Add a Subwoofer Harness **HIGH LEVEL INPUT WITH MOLEX PLUG**

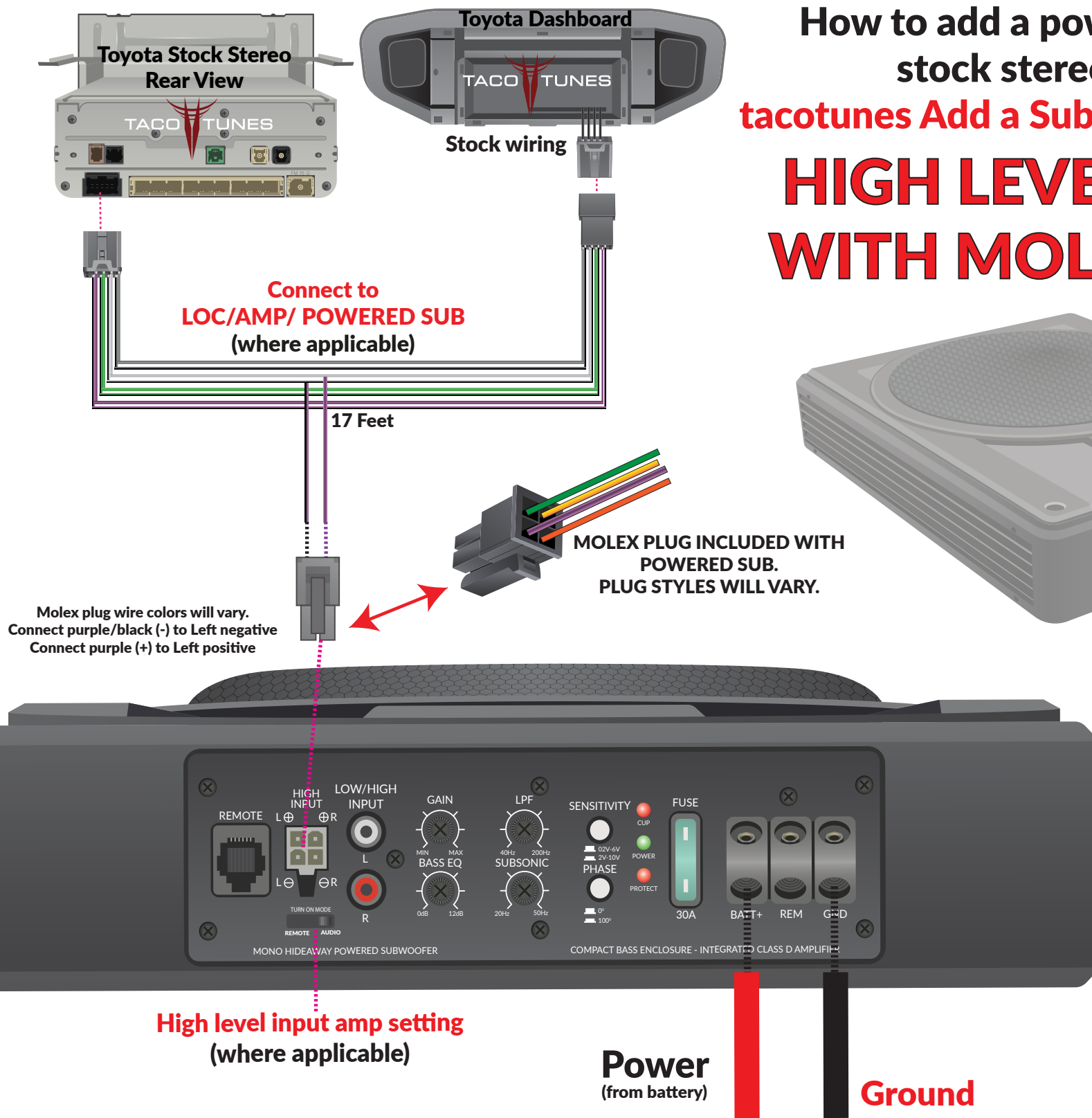

TACO TUNES

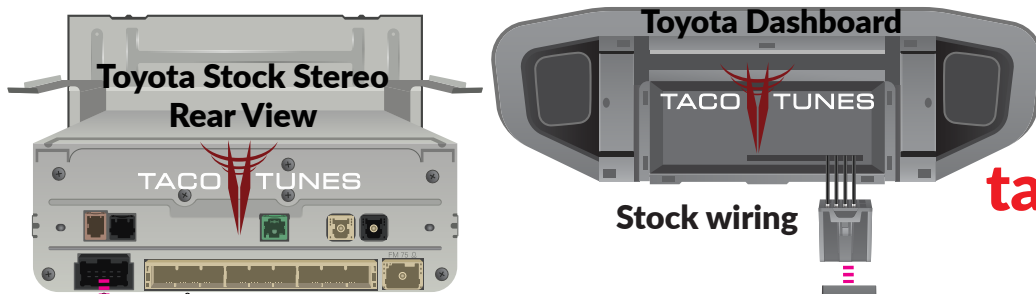

# How to add a powered sub to stock stereo using tacotunes Add a Subwoofer Harness HIGH LEVEL INPUT WITH RCA ADAPTER

**Tacotunes  
Add a Subwoofer Harness**

**Connect to  
LOC/AMP/ POWERED SUB  
(where applicable)**

17 Feet

**Connect harness to RCA adapter accordingly:**  
**Purple (+) : Positive**  
**Purple/Black (-) : Negative**

RCA adapters available  
on our website



**Power  
(from battery)**

**Ground**

# How to add a powered sub to stock stereo using **tacotunes Add a Subwoofer Harness.** **LOW LEVEL INPUT WITH** **AUDIO CONTROL LC2i PRO**

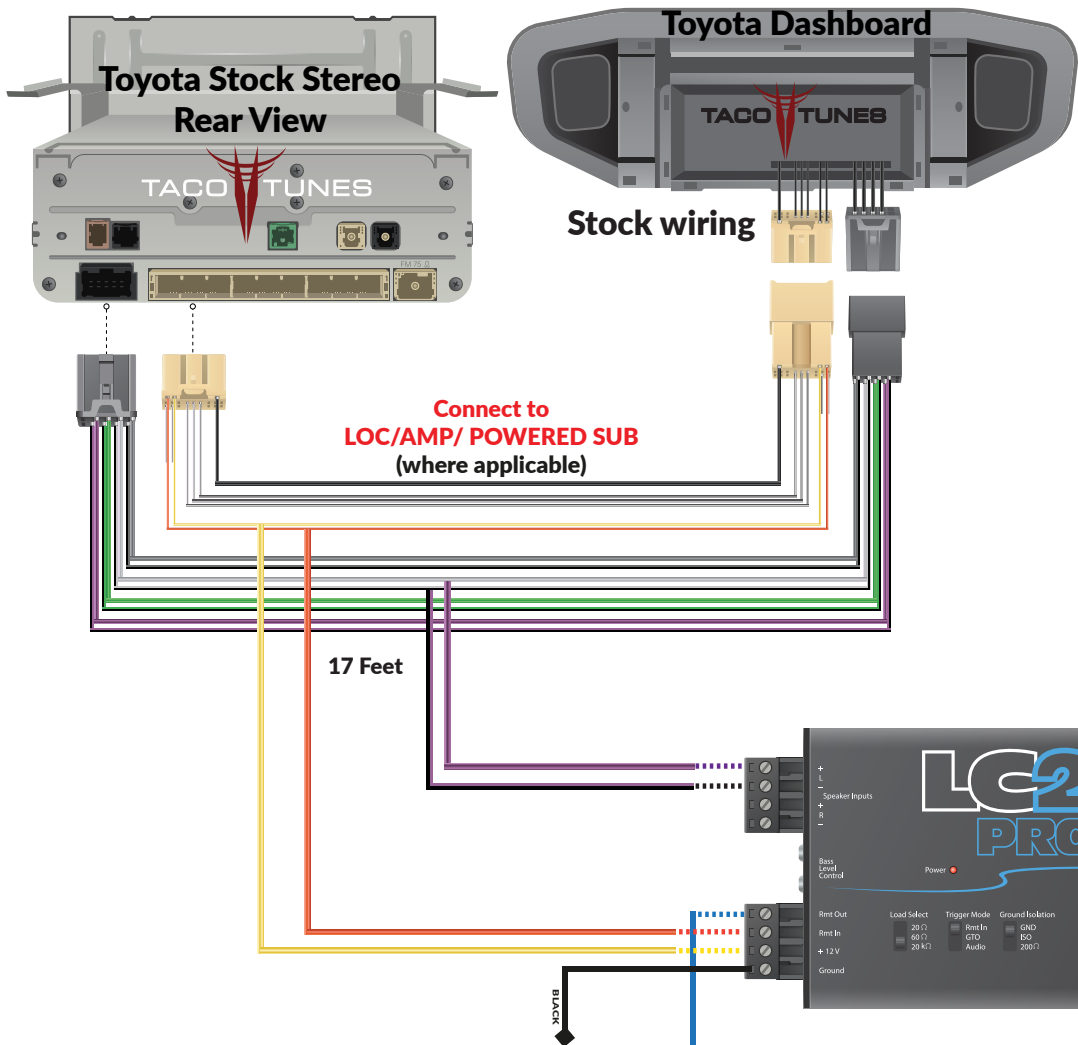

REMOTE TURN ON TRIGGER WIRE

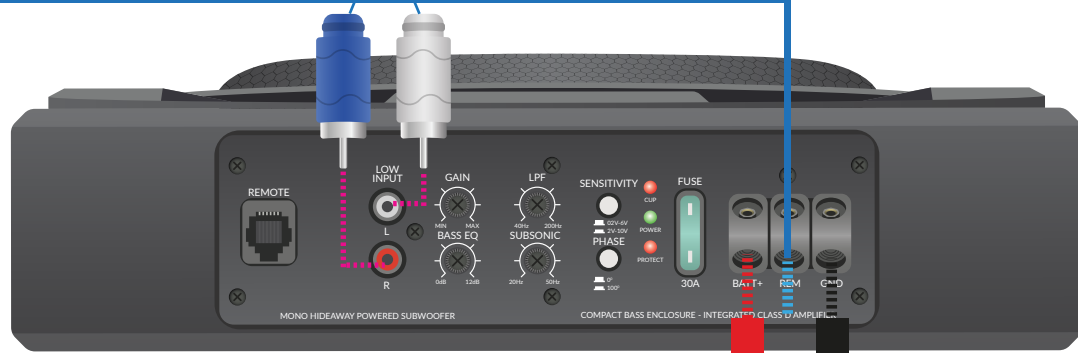

**Power**  
(from battery)

**Ground**

# How to add a powered sub to stock stereo using tacotunes Add a Subwoofer Harness. **LOW LEVEL INPUT WITH POWERED 2 CHANNEL LOC**

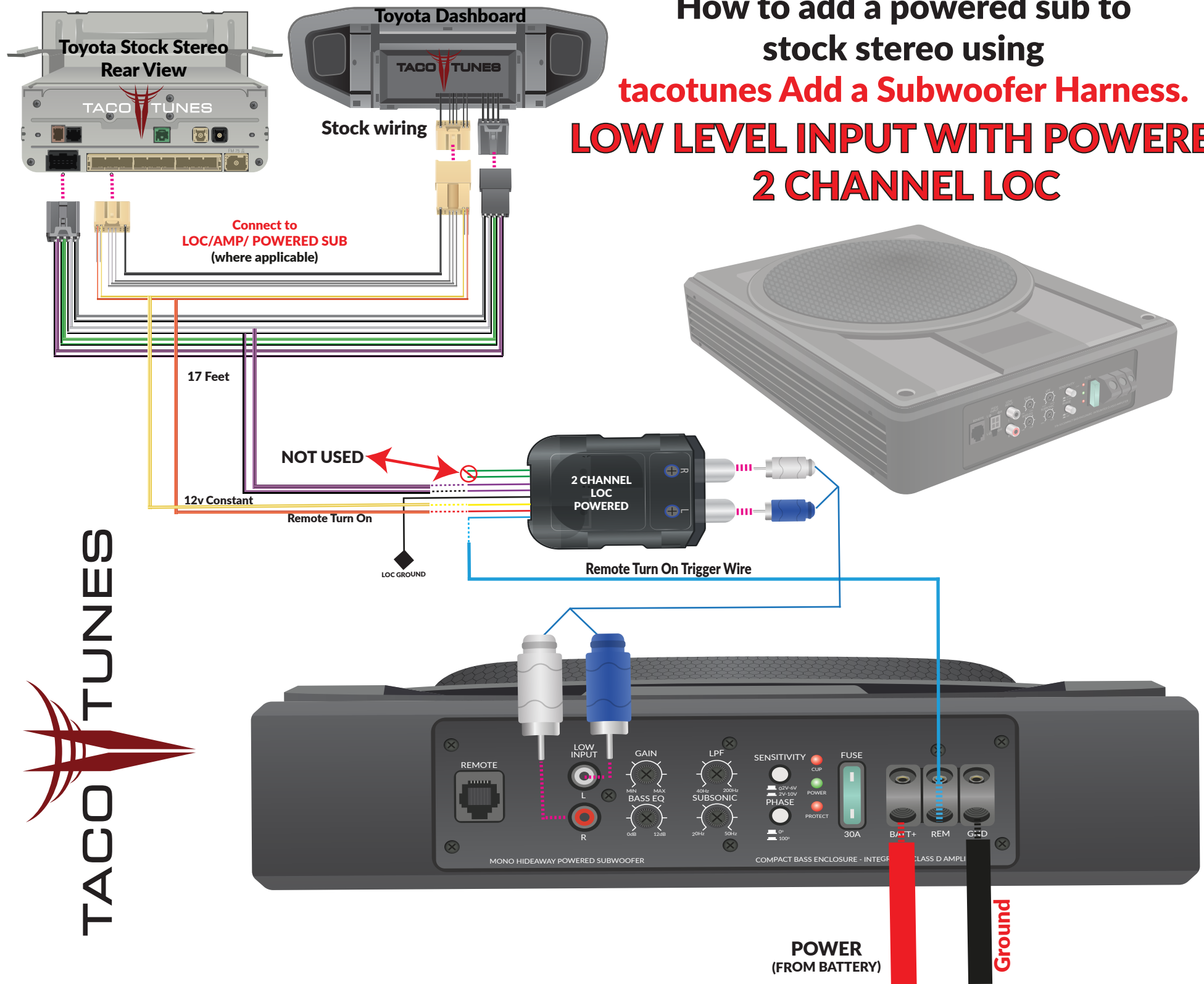

**TACO TUNES**

## LOW LEVEL INPUT WITH 2 CHANNEL LOC

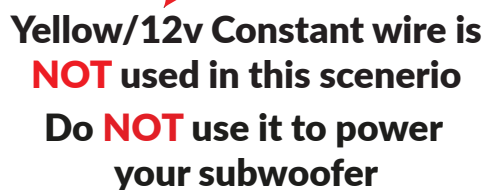

[Click here for notes on how to set up your powered sub and list of FAQ](#)

Example Powered Subwoofer

