

Listed below are the links to guide you through the installation of your tacotunes.com powered subwoofer enclosure with a factory head unit.

## **Power Wire:**

VIDEOS –

How to get power wire through firewall-

*DO NOT RUN TO PASSENGER SIDE, FOLLOW DRIVER'S SIDE KICK PLATE FACTORY WIRING AND RUN TO REAR WALL ACCORDING TO THE FOLLOWING LINKED INSTALL VIDEO*

[Toyota Tundra run / install power cable from battery to amplifier and install fuse.](#)

How to run power wire -

[2007-2021 Toyota Tundra How to run amplifier power wire to rear powered subwoofer - install steps.](#)

## **How to wire subwoofer to the amplifier:**

<https://tacotunes.com/wp-content/uploads/2025/10/How-to-wire-subwoofer.pdf>

## **Powered Subwoofer Amplifier Connections, Ground, and Bass Control Knob:**

VIDEO –

[2007-2021 Toyota Tundra Powered Subwoofer Power & Signal Connections and Ground Bass Knob Install - YouTube](#)

# PLUG AND PLAY WIRING CONNECTIONS

## WITHOUT Factory Amp under seat:

*Connections for 2007-2013 NON JBL Tundra OR 2014-2021 Tundra WITHOUT Factory amp under passenger seat are made behind the head unit*

## Head Unit Removal:

*DO NOT REMOVE ALL OF YOUR HEAD UNIT'S CONNECTIONS.*

How to remove the head unit [2014-2021 Tundra](#) -

[How to remove stereo from 2014 2015 Toyota Tundra](#)

How to remove the head unit [2007-2013 Tundra](#) -

[Toyota Tundra 2007- 2013 How to remove stock stereo head unit and install new amplifier - YouTube](#)

## Head unit Connections:

### 2007-2013 Tundra-

<https://tacotunes.com/wp-content/uploads/2025/09/2007-2013-TUNDRA-PS-WITHOUT-FACTORY-AMP-INSTALLATION-DIAGRAM.pdf>

### 2014-2021 Tundra WITHOUT Factory Amp-

<https://tacotunes.com/wp-content/uploads/2025/09/2014-2021-TUNDRA-PS-WITHOUT-FACTORY-AMP-INSTALLATION-DIAGRAM.pdf>

## Run wiring from head unit to powered subwoofer:

VIDEO –

[Toyota Tundra 2007 2013 How to install plug and play amplifier harnesses](#)

Minute 0:00-6:00

Once you reach minute 6:00, run the harness under your carpet, following the same process as the power wire, except this time you are on the passenger side

## WITH Factory Amp under seat:

*Connections for 2007-2021 JBL Tundra's OR 2014-2021 NON-JBL Tundra's WITH the Factory amp under passenger seat are made at the factory amp under your front passenger seat.*

- Remove the 4 seat bolts and lean your passenger front seat back to give you access to the factory amplifier. Be careful not to pull on your air bag wire harnesses under your seat.

**Follow the first minute in this video to gain access to your factory amplifier connections. Do NOT remove the amplifier completely.**

Video-

<https://www.youtube.com/watch?v=5RnG-amV5l4>

## Factory Amplifier Connections:

Run your plug and play harness under your carpet, following the same process as the power wire, except this time you are on the passenger side

### **2007-2021 JBL EQUIPPED-**

<https://tacotunes.com/wp-content/uploads/2025/09/2007-2021-POWERED-SUBWOOFER-JBL-EQUIPPED-INSTALLATION-DIAGRAM.pdf>

### **2014-2021 NON-JBL EQUIPPED-**

<https://tacotunes.com/wp-content/uploads/2025/09/2014-2021-TUNDRA-PS-WITH-FACTORY-AMP-INSTALLATION-DIAGRAM.pdf>

## How to tune your Powered Subwoofer:

DIAGRAM - <https://tacotunes.com/wp-content/uploads/2025/11/2007-2021-V3-TUNING-DIAGRAM.pdf>

# 2014-2021 Tundra How to Install Subwoofer Enclosure:

VIDEO -

[How to install ported 12" subwoofer box Toyota Tundra 2014-2021](#)

# 2007-2013 Tundra How to Install Subwoofer Enclosure:

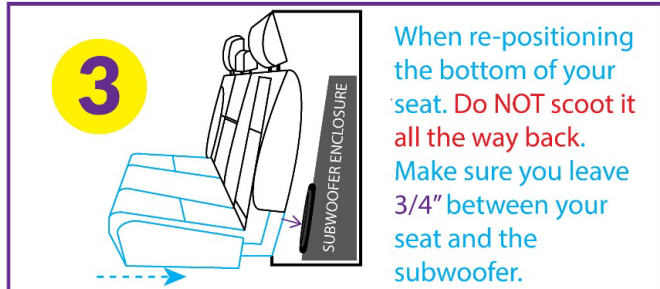
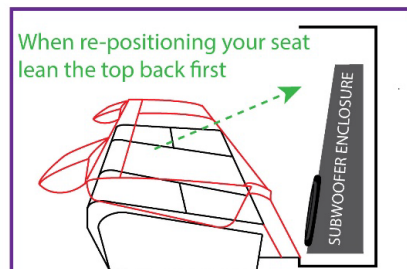
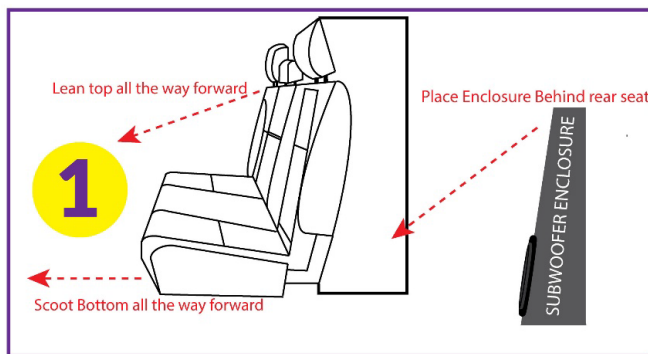

tacotunes.com

**Failure to adhere to these steps will damage your subwoofer and void the warranty**